

Bethlehem Landfill Company

OCTOBER 19, 2022
LOWER SAUCON TOWNSHIP
COUNCIL MEETING
PROPOSED ZONING ORDINANCE AMENDMENTS
FOR FUTURE EXPANSION

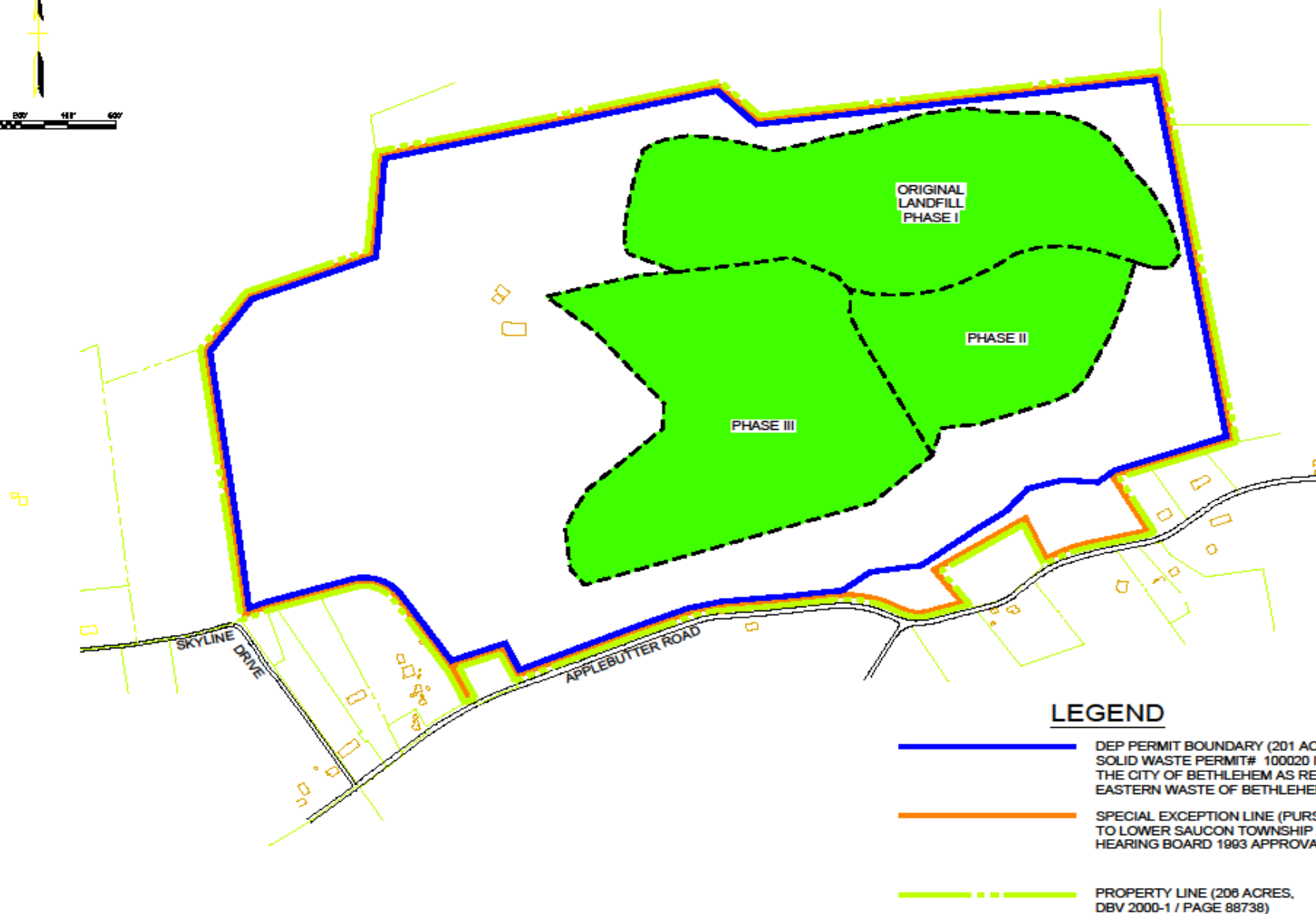
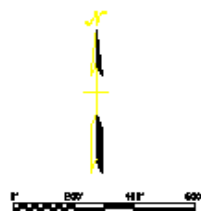

LEGEND

- DEP PERMIT BOUNDARY (201 ACRES, 1993 SOLID WASTE PERMIT# 100020 ISSUED TO THE CITY OF BETHLEHEM AS REISSUED TO EASTERN WASTE OF BETHLEHEM IN 1998)
- SPECIAL EXCEPTION LINE (PURSUANT TO LOWER SAUCON TOWNSHIP ZONING HEARING BOARD 1993 APPROVAL)
- PROPERTY LINE (206 ACRES, DBV 2000-1 / PAGE 88738)

Status Prior to 2000

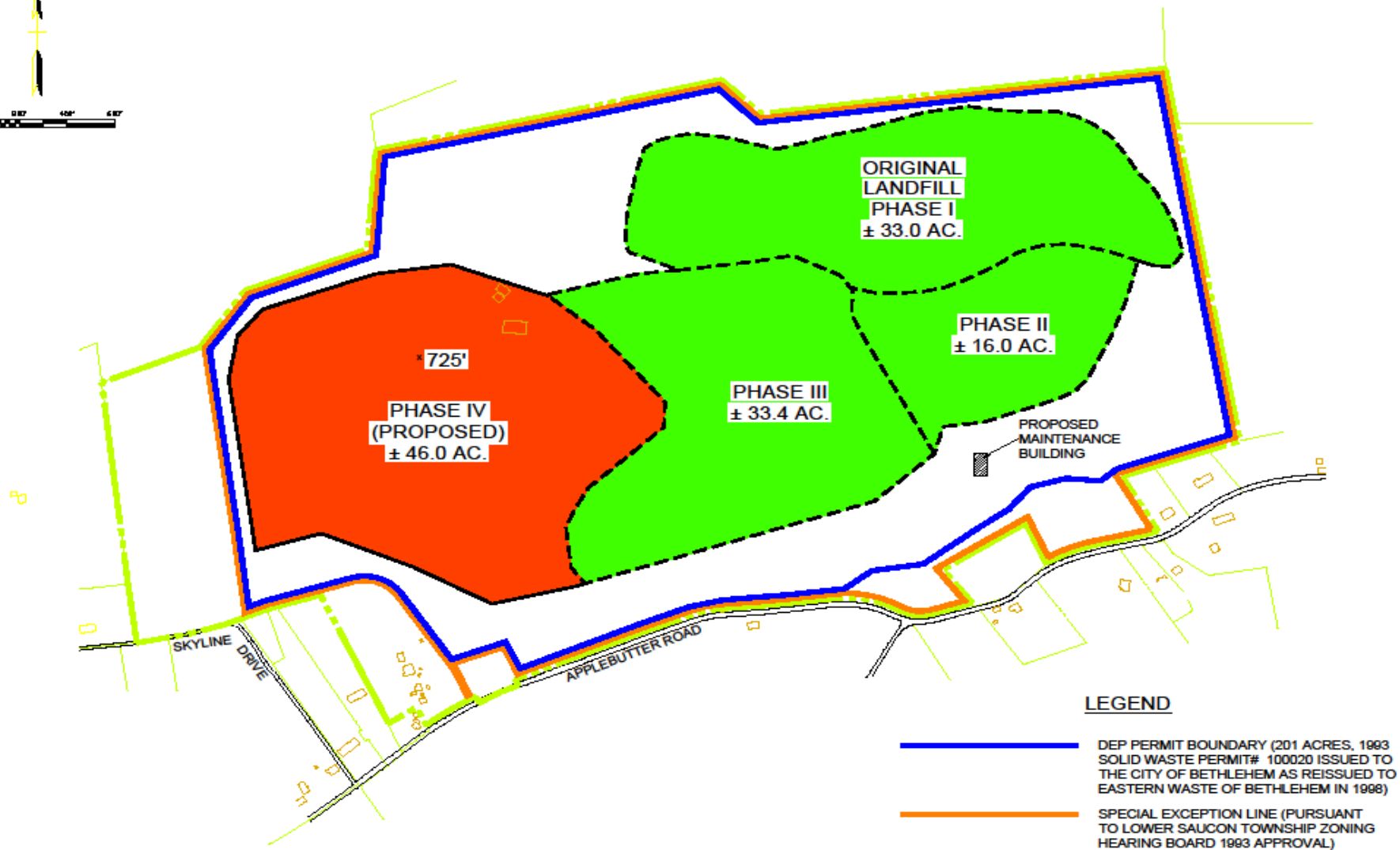
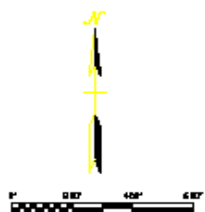

Phase IV

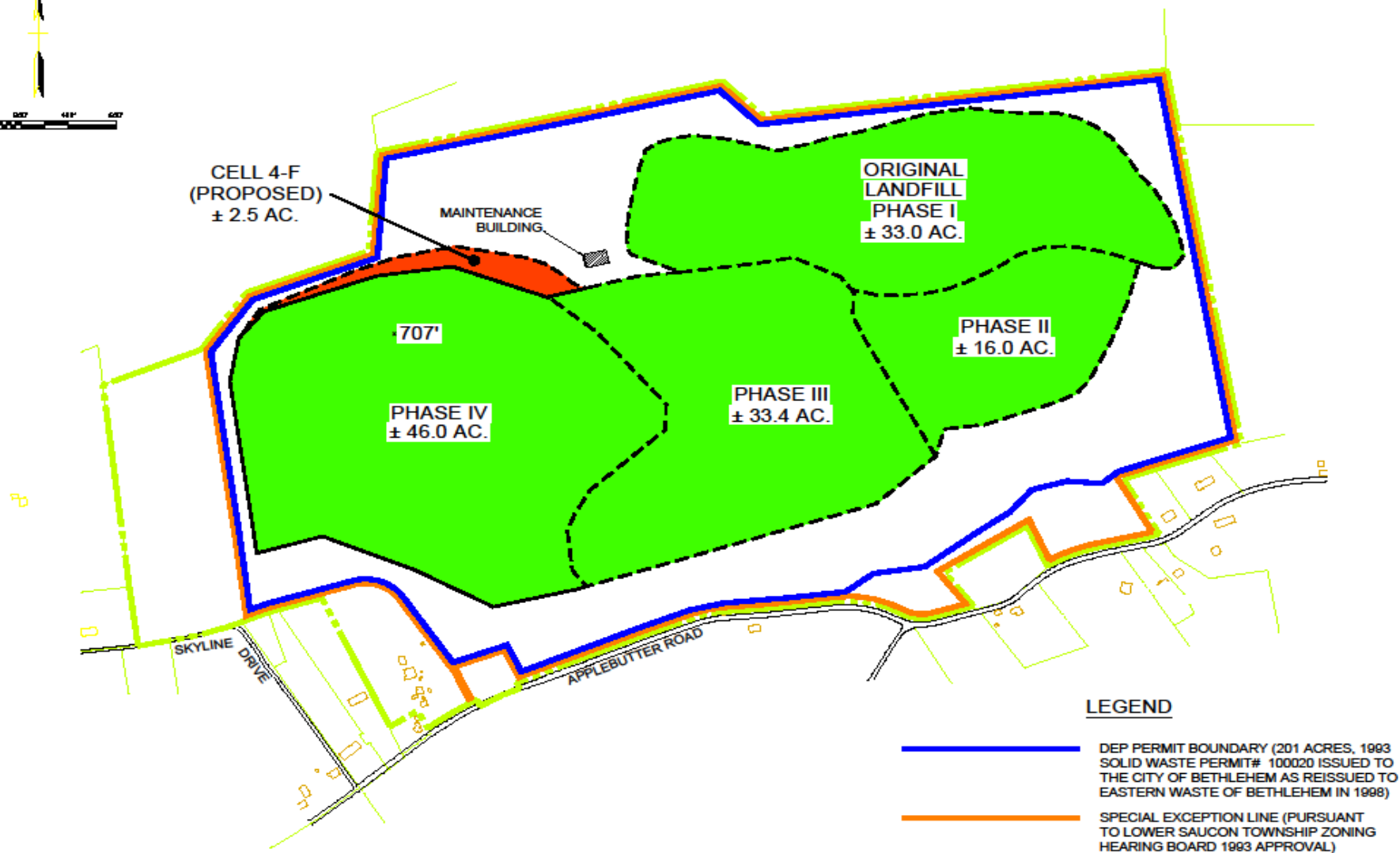
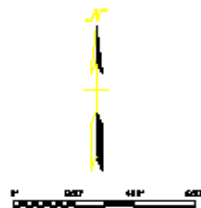

Cell 4-F

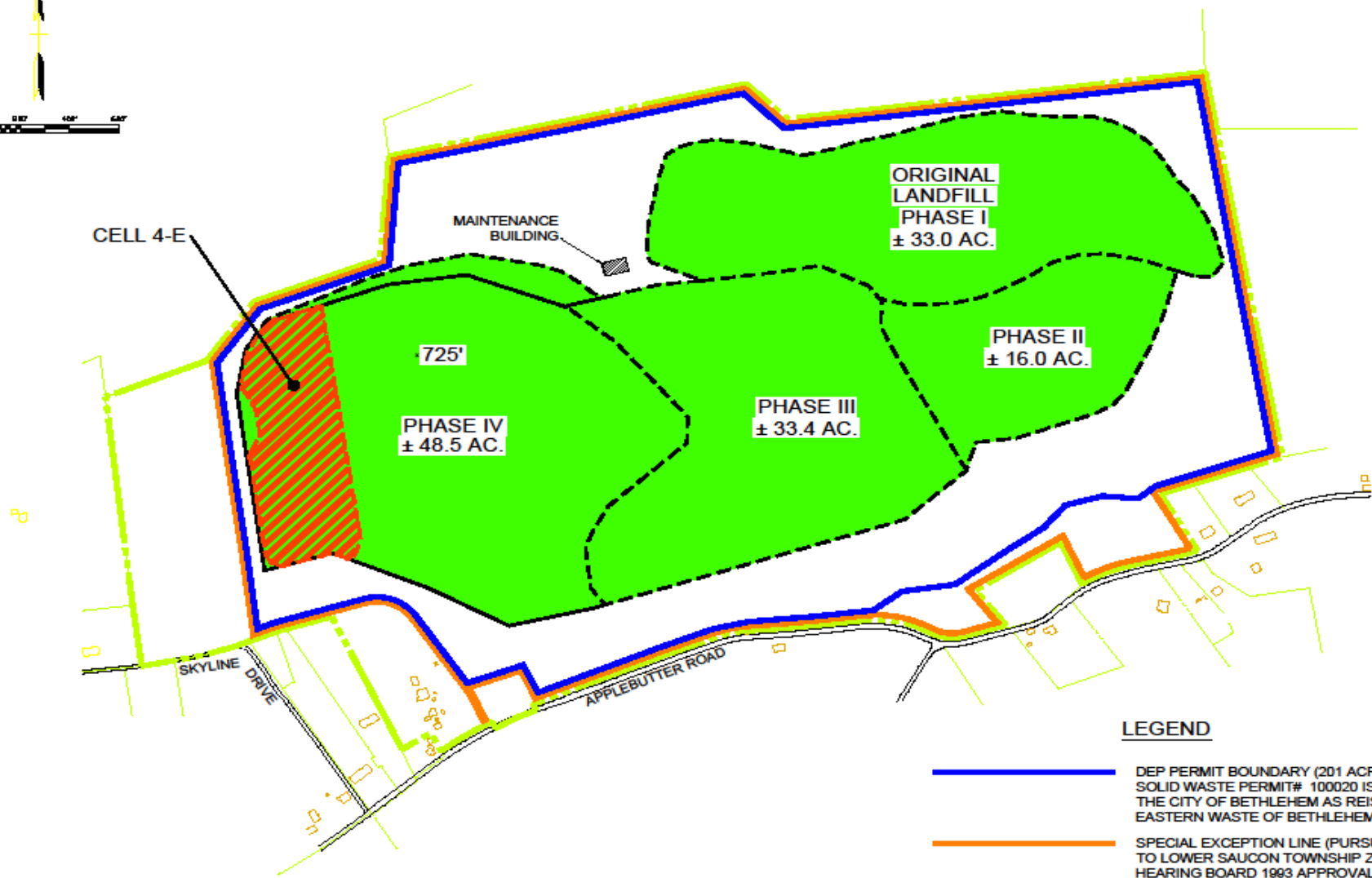
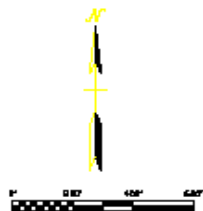

Cell 4-E

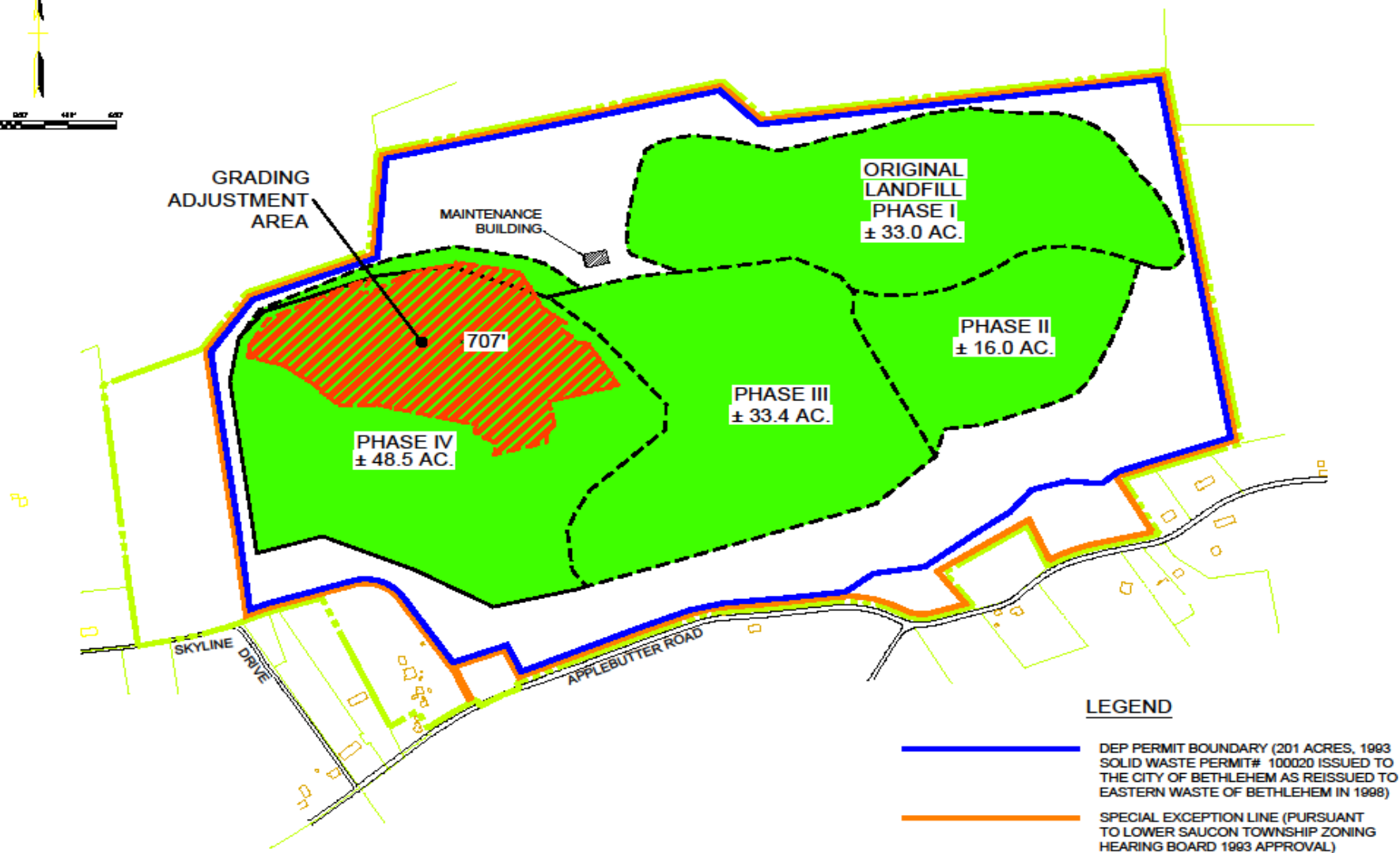
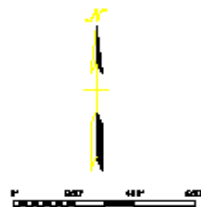

Grading Adjustment

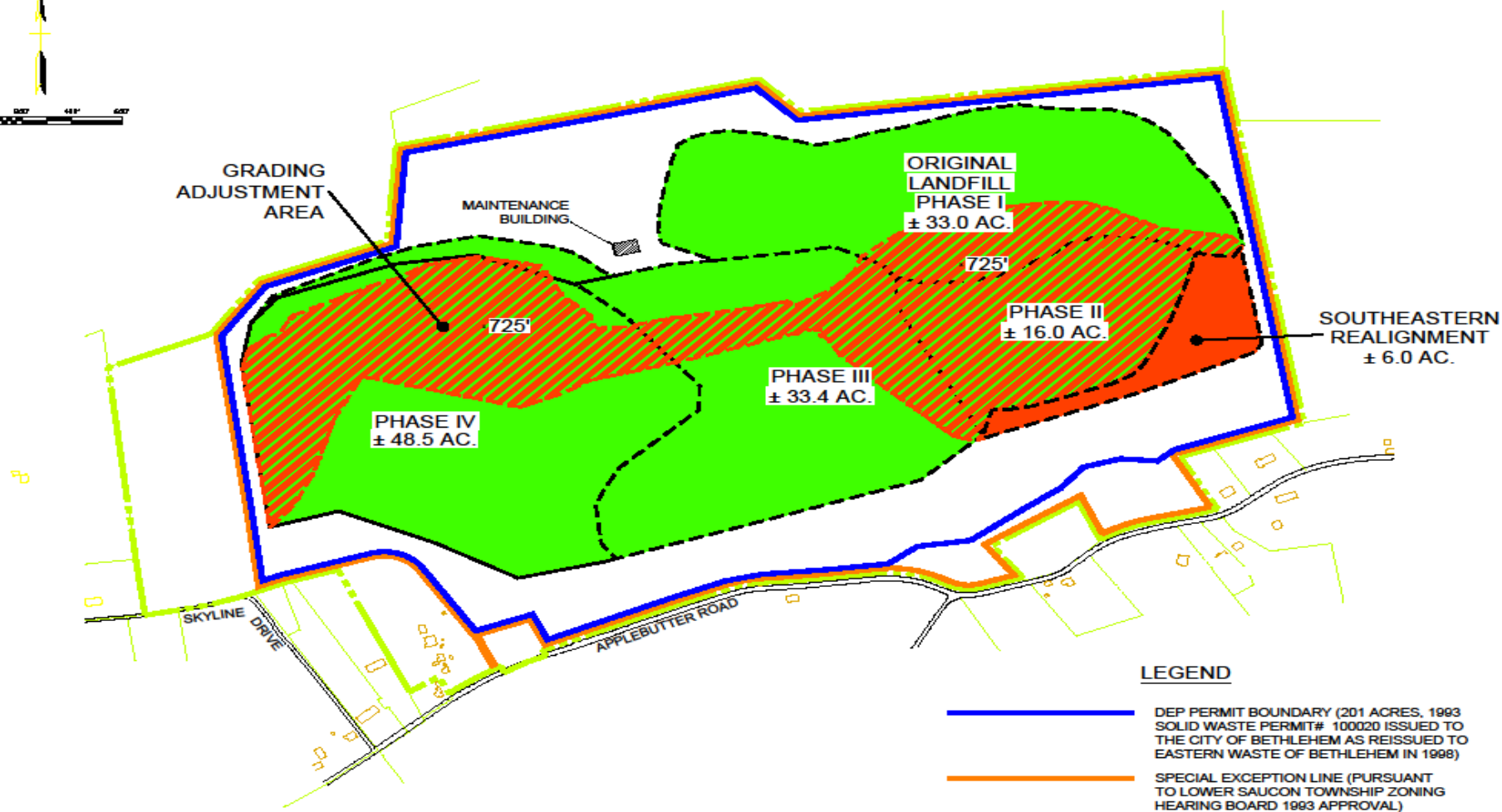

Grading Adjustment – Southeastern Realignment

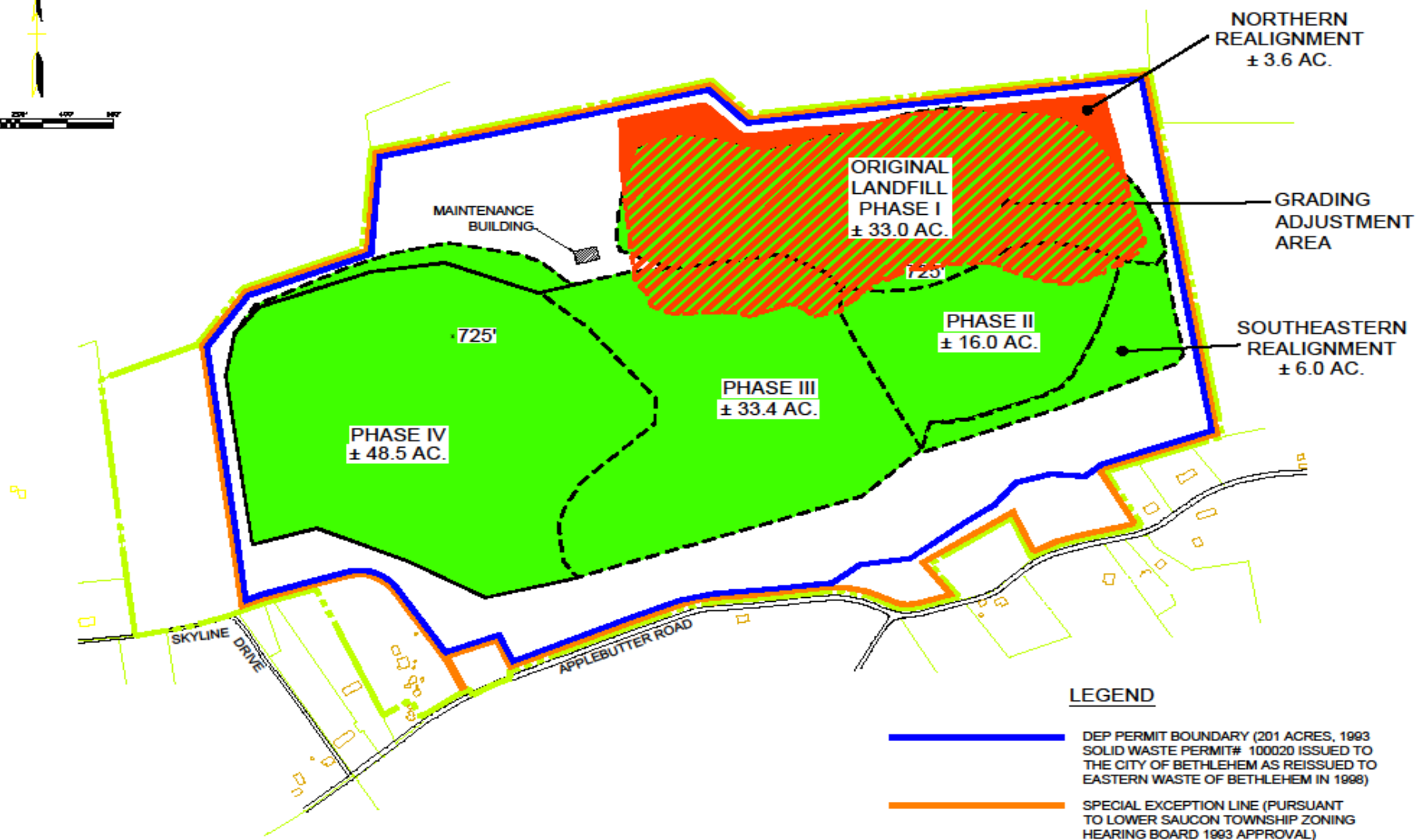
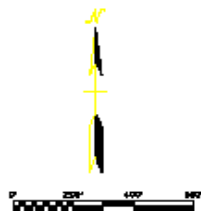

Northern Realignment Plan

Remaining Operating Capacity

- ▶ Including the Northern Realignment (currently pending before PADEP) the Landfill has approximately 6 years of remaining life.



KEY

- PROPERTY LINE



- PROPERTIES RECENTLY ACQUIRED
BY BETHLEHEM LANDFILL COMPANY



APPROXIMATE SCALE: 1" = 300'

1162_6BLC22-02.dwg

Property Plan

Expansion of the Landfill is a Multi-Step Process that Will Take Several Years to Secure.

- ▶ Map and Text Amendments are the First Step

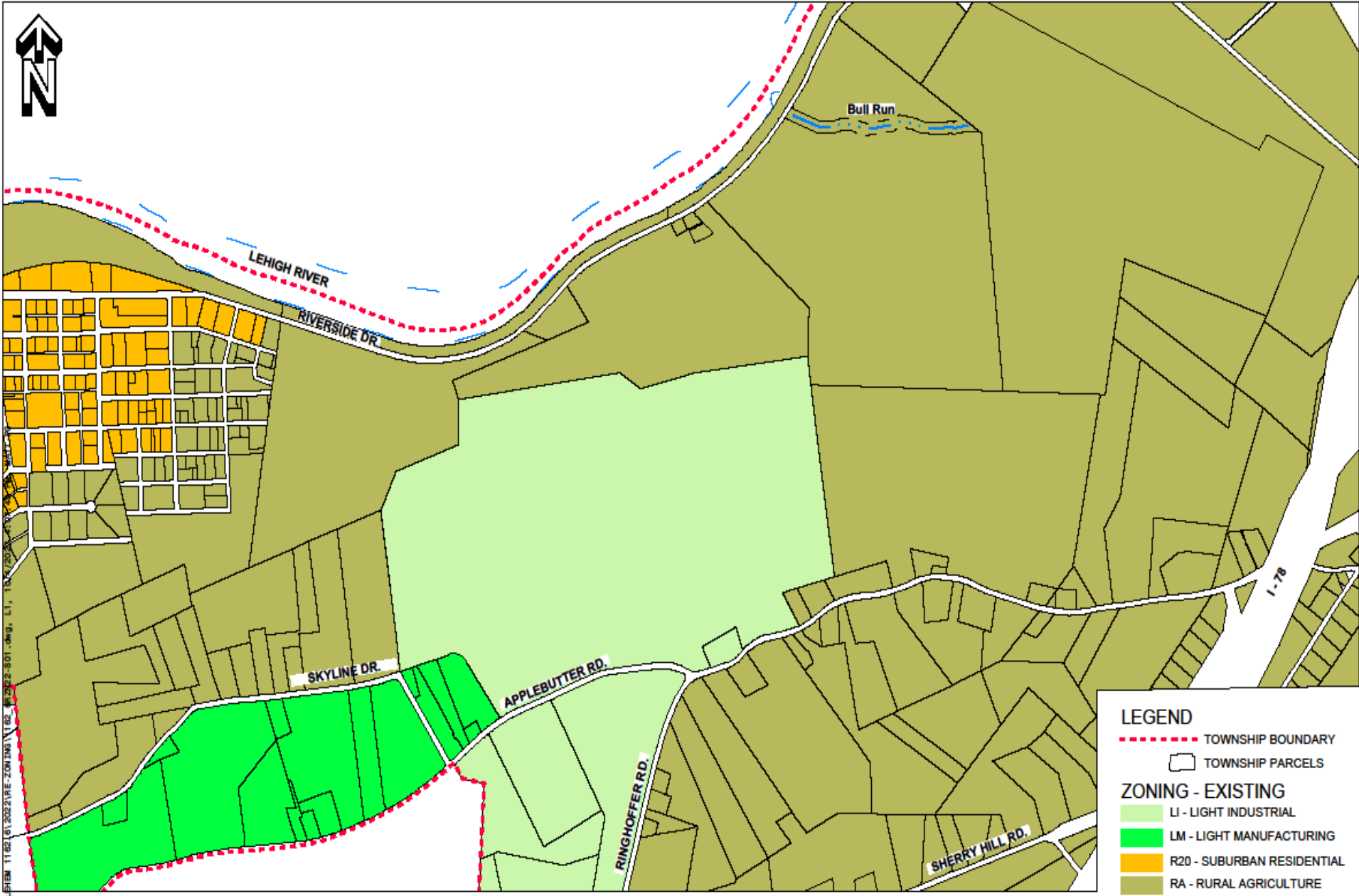

Existing Zoning

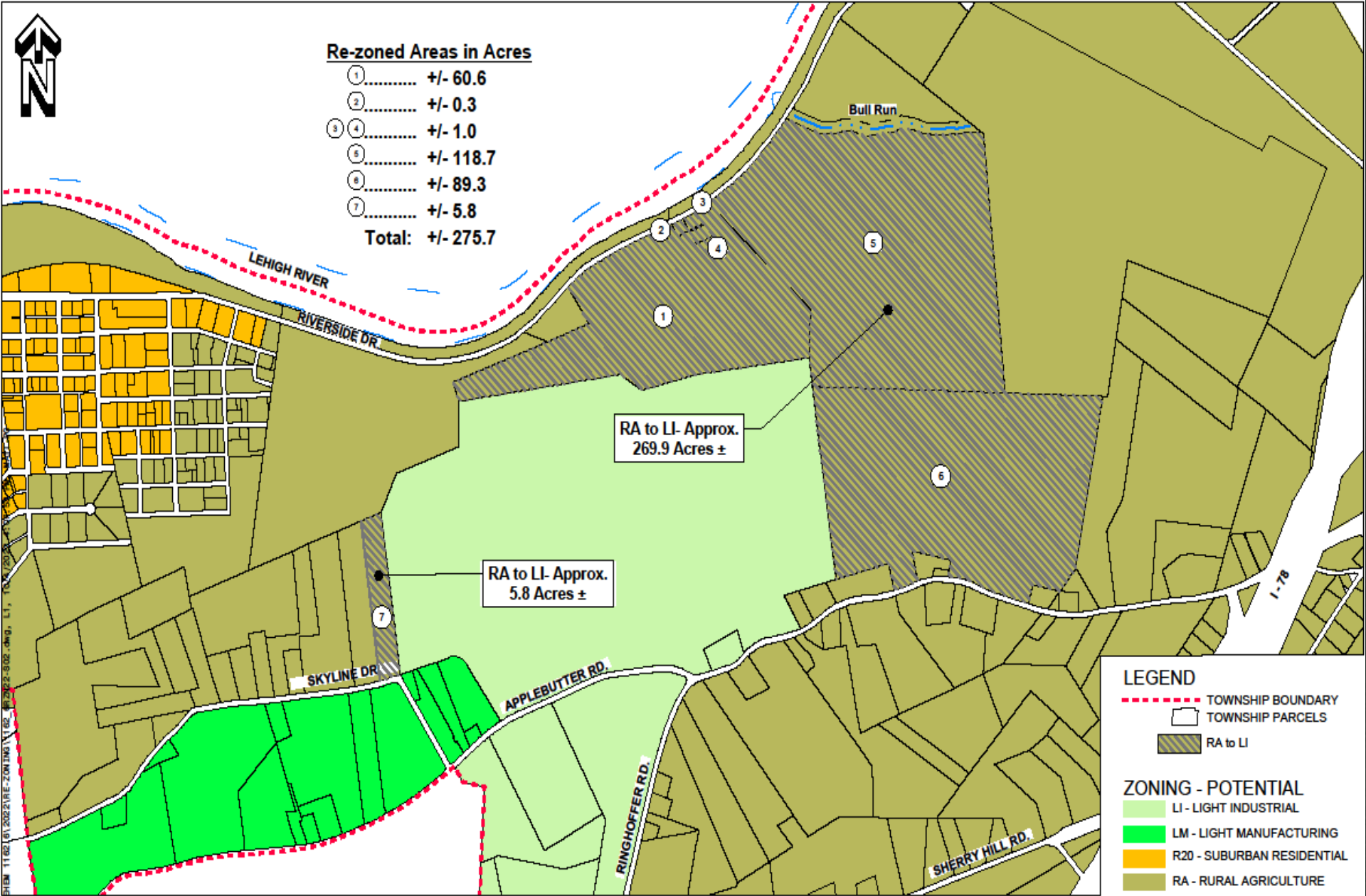

Map Amendment

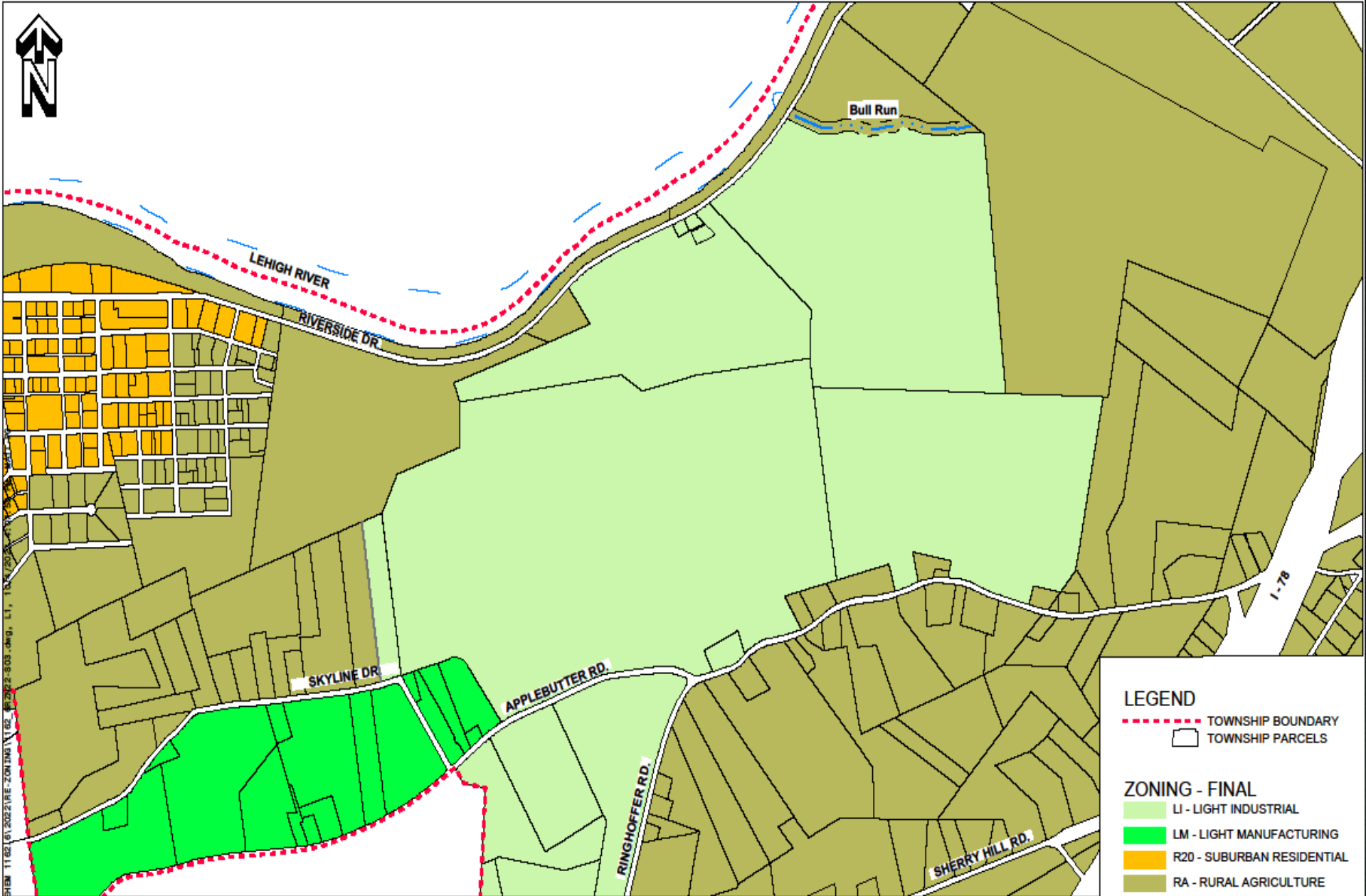

Map Amendment

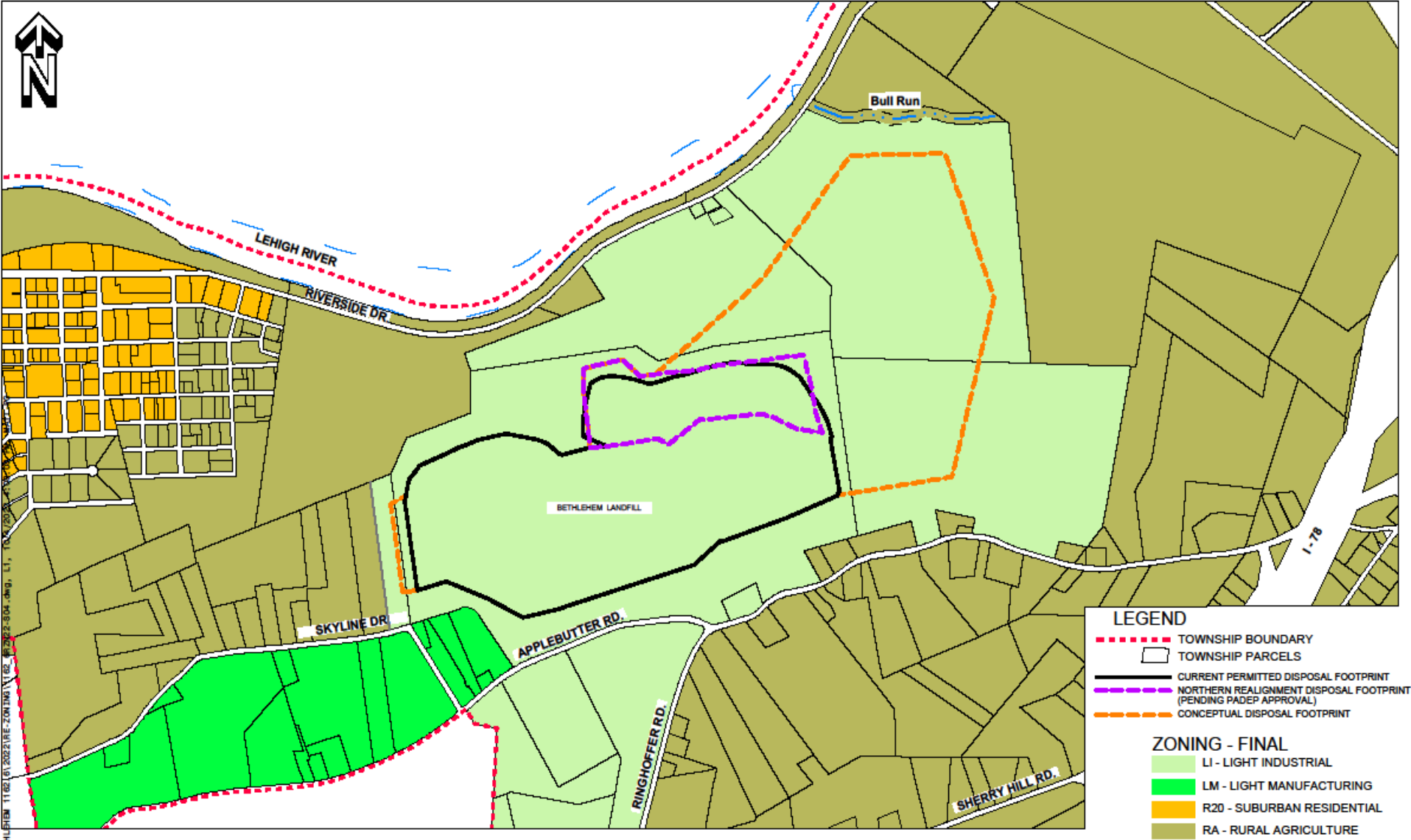

Conceptual Disposal Footprint
(maximum)

Text Amendments

- ▶ Natural Resource Mitigation Alternative
- ▶ Site Plan Exemption

The Requested
Map/Text
Amendments are
the First Step
Towards a Future
Expansion of the
Landfill.
Others Include:

- ▶ Amendment of Host Agreement;
- ▶ Lifting of Landfilling Restriction;
- ▶ Zoning Approval; and
- ▶ PADEP Permit(s).

Bethlehem Landfill Company

OCTOBER 19, 2022
LOWER SAUCON TOWNSHIP
COUNCIL MEETING
PROPOSED ZONING ORDINANCE AMENDMENTS
FOR FUTURE EXPANSION