

TRAIL SIGNING & PAVEMENT MARKING
N.T.S.

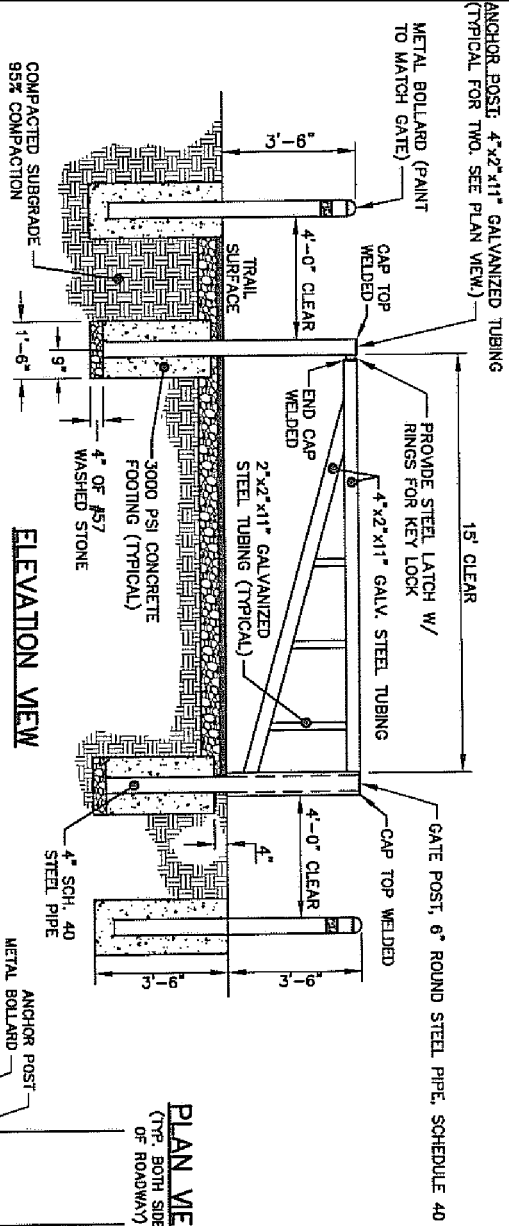

- NOTES:
- 1) ALL METAL SHALL BE GALVANIZED, PRIMERED AND PAINTED. USE ONE COAT HAMMERITE PRIMER AND TWO COATS BENJAMIN MOORE HUNTER GREEN METAL ENAMEL.
 - 2) ALL JOINTS SHALL BE WELDED SOLID.
 - 3) ALL DIMENSIONS SHALL BE TO THE TOWN OF CARP.
 - 4) 3" DIAMETER REFLECTORS WITH GALVANIZED METAL BACKS SHALL BE ATTACHED TO THE STREET/TRAILHEAD SIDE OF THE GATE, ON ALL POSTS AND IN CENTER OF GATE ARM.

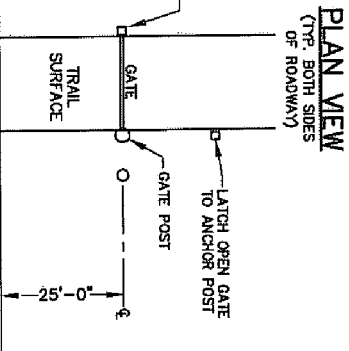

METAL GATE / BOLLARD AT ROADWAY CROSSING

001RT
SHEET 1 OF 1

SECTION AA TYP
N.T.S.

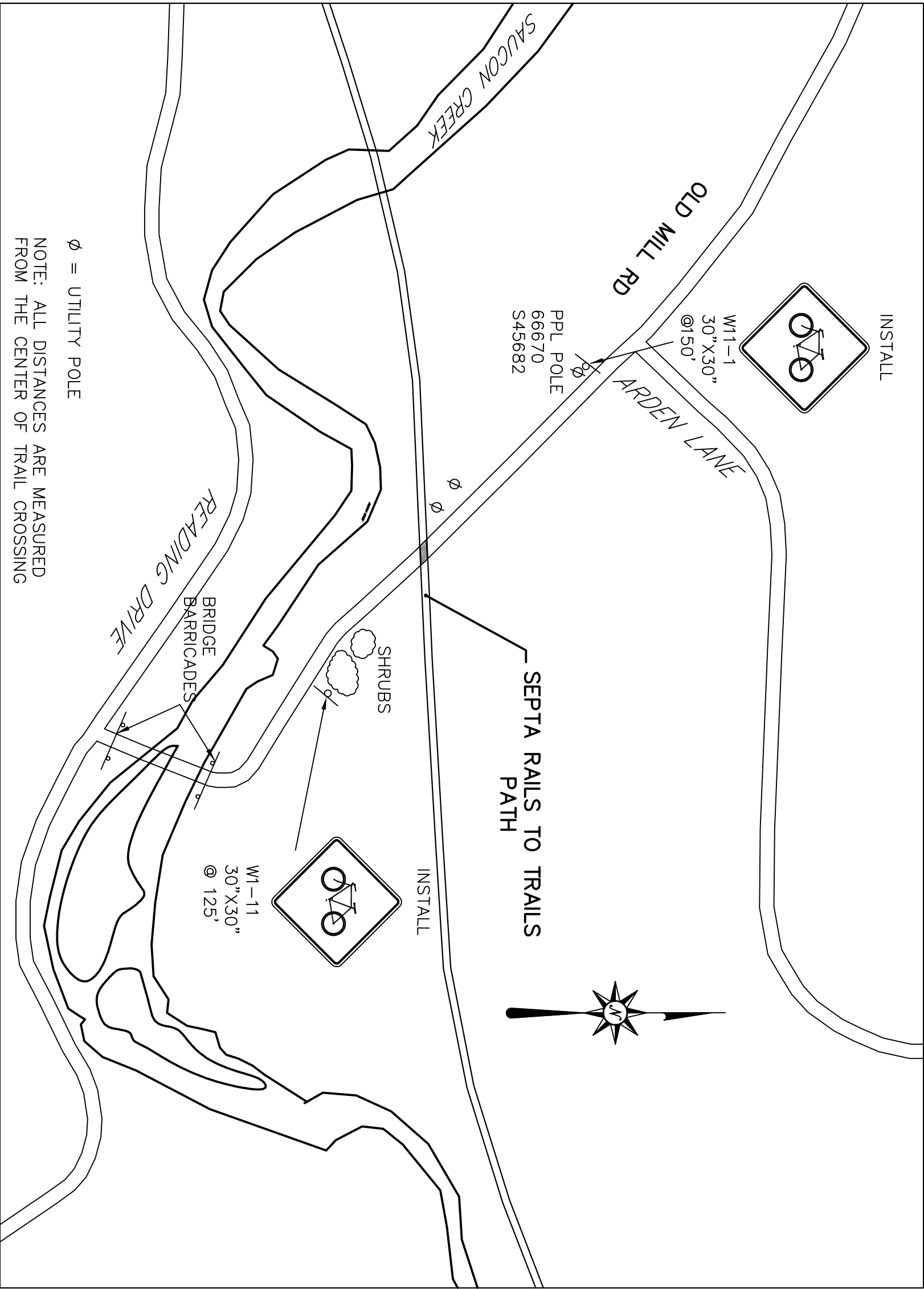

ROADWAY SIGNING PLAN
N.T.S.

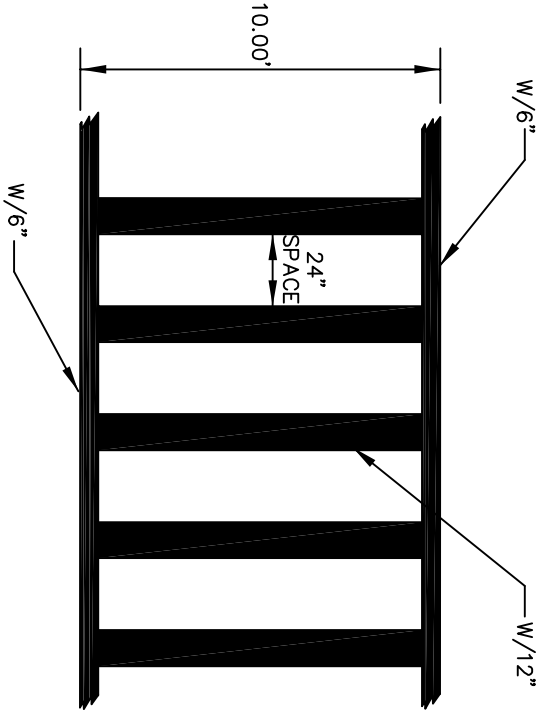

CROSSWALK STRIPING DIAGRAM
N.T.S.

NOTE: STRIPING RUNS
PARALLEL TO ROAD

REQUIRED SIGN LIST
OLD MILL ROAD CROSSING

| SIGN NUMBER | DESCRIPTION | SIZE | # REQ'D |
|---------------------------|--|---------|---------|
| R1-1 | STOP | 30"X30" | 4 |
| W11-1 | BICYCLE CROSSING | 30"X30" | 2 |
| R5-3 | NO MOTOR VEHICLES | 24"X24" | 2 |
| R8-3A | NO PARKING SYMBOL | 12"X12" | 4 |
| SS-1 SUGGESTED SIGN | WARNING! DISMOUNT BIKES AND WALK ACROSS THE STREET | 24"X30" | 2 |
| R1-6 | YIELD TO PEDESTRIANS IN CROSSWALK | 12"X36" | 2 |

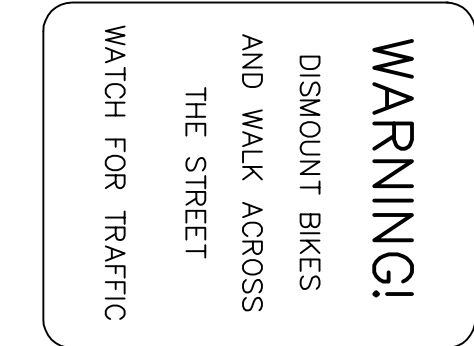

SS-1

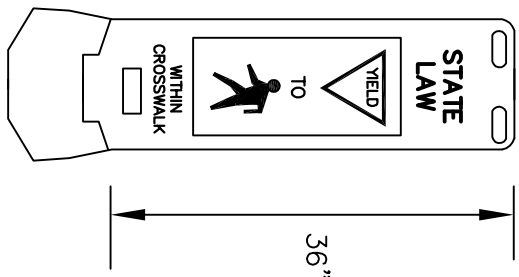

R1-6

SUGGESTED SIGN
N.T.S.

NOTE: RED LEGEND
ON WHITE BACKGROUND
CROSSWALK
SIGN

OLD MILL ROAD CROSSING

SEPTA RAILS TO TRAILS

| PROJECT NO. | | | |
|-------------|--|--|--|
| LS08-44 | | | |
| SHEET NO. | | | |
| 01 OF 01 | | | |

Hanover
Engineering Associates Inc
252 Brodhead Road, Suite 100
Bethlehem, PA 18017-8944
610.691.5644
Fax 610.691.6968