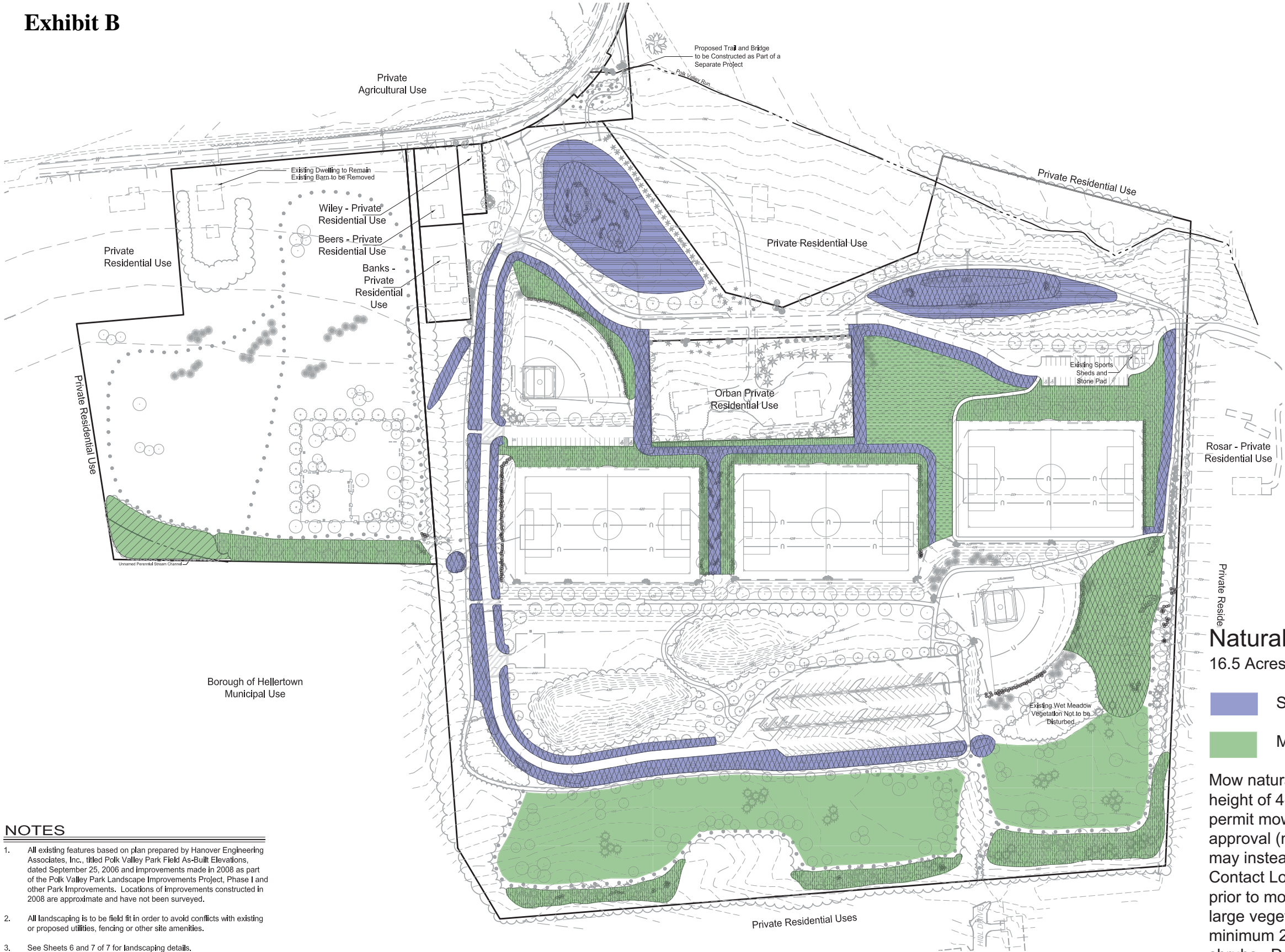

Exhibit B



LEGEND	
	EXISTING BOUNDARY
	EXISTING BUILDINGS
	EXISTING BOLLARD
	EXISTING CENTERLINE
	EXISTING CONTOUR
	EXISTING INDEX CONTOUR
	EXISTING DRIVEWAY
	EXISTING EDGE OF PAVEMENT
	EXISTING EDGE OF ROAD
	EXISTING EDGE OF STONE
	EXISTING CHAINLINK FENCE
	EXISTING SPLIT RAIL FENCE
	EXISTING LEGAL RIGHT-OF-WAY
	EXISTING SIGN
	EXISTING STORM SEWER AND STRUCTURES
	EXISTING STORM UNDER DRAIN
	EXISTING STREAM
	EXISTING WALKING TRAIL
	EXISTING TREELINE
	EXISTING UTILITY POLE
	EXISTING WATER LINE AND STRUCTURES
	EXISTING SHRUBS AND TREES
	EXISTING BENCHES
	EXISTING EMERGENCY GATE
	EXISTING PET WASTE DISPOSAL STATION
	PROPOSED SPLIT RAIL FENCE
	PROPOSED GRASS PATH
	PROPOSED DECIDUOUS TREE
	PROPOSED FLOWERING TREE
	PROPOSED EVERGREEN
	PROPOSED SHRUBS
	PROPOSED PLUG PLANTINGS

Naturalized Areas Mowing Schedule
16.5 Acres +/-
March 28, 2012

Stormwater Management Area

Meadow Area

Mow naturalized areas once annually in early spring to a height of 4-6" prior to April 1st. Where weather does not permit mowing prior to April 1st, and with Township approval (must be obtained prior to March 15th) mowing may instead be done between July 5th and July 31st. Contact Lower Saucon Township a minimum of 2 weeks prior to mowing naturalized areas so that shrubs and other large vegetation may be flagged for visibility. Leave a minimum 2' unmown buffer around flagged trees and shrubs. Do not mow within naturalized areas at any other time than those indicated here.

NOTES

- All existing features based on plan prepared by Hanover Engineering Associates, Inc., titled Polk Valley Park Field As-Built Elevations, dated September 25, 2006 and improvements made in 2008 as part of the Polk Valley Park Landscape Improvements Project, Phase I and other Park Improvements. Locations of improvements constructed in 2008 are approximate and have not been surveyed.
- All landscaping is to be field fit in order to avoid conflicts with existing or proposed utilities, fencing or other site amenities.
- See Sheets 6 and 7 of 7 for landscaping details.

Written dimensions shall have priority over scaled dimensions. All dimensions, elevations, locations, and conditions, shall be verified by the Contractor prior to construction, and the Owner and Boucher & James, Inc. shall be notified of any discrepancies with the information shown on drawings.

Only those plans incorporating the raised or red ink professional seal shall be considered official and relied upon. All ideas, designs and arrangements presented hereon were developed for use on, and in connection with, the specified project being prepared for the Owner. These plans may not be reproduced or altered without the expressed written permission of Boucher & James, Inc.

Information shown on this plan represents professional services expressing ideas and designs developed, owned and copyrighted by Boucher & James, Inc. Reproduction of this plan without written approval of Boucher & James, Inc. is not permitted. Unauthorized reproduction of a copy of this plan for any purpose will be considered a violation of the copyright laws and a theft of corporate assets. Unauthorized alterations of the plan will be considered a violation of the professional code of ethics. Any violation will be prosecuted to the fullest extent of current statutes.

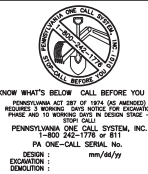

REVISIONS :	
DATE	DESCRIPTION

PROJECT :	POLK VALLEY PARK LOWER SAUCON TOWNSHIP NORTHAMPTON COUNTY
APPLICANT :	LOWER SAUCON TOWNSHIP 3700 OLD PHILADELPHIA PIKE BETHLEHEM, PA

JOB NO.:	0995023
DRAWN BY:	V.S.
CHECKED BY:	JSG
SCALE:	1" = 100'
PLAN STATUS:	CONSTRUCTION

TITLE		SHEET	
LANDSCAPE PLAN - PHASE TWO SEEDING		4 OF 7	
Boucher & James, Inc. CONSULTING ENGINEERS CORPORATE HEADQUARTERS, 1456 FERRY RD., BUILDING 500 DOYLESTOWN, PA. 18901 PH. 215.345.9400 ; FAX. 215.345.9401		STROUDSBURG OFFICE, 910 RIM ROCK ROAD STROUDSBURG, PA. 18360 PH. 570.629.0300 ; FAX. 570.629.0306 www.BJEngineers.com	
POLK VALLEY PARK		May 15, 2009	